

**CONFIDENTIAL**  
 The reproduction, distribution and utilization of this document as well as the communication of its contents to others without express authorization is prohibited. Offenders will be held liable for the payment of damages. All rights reserved in the event of the grant of a patent, utility model or design.

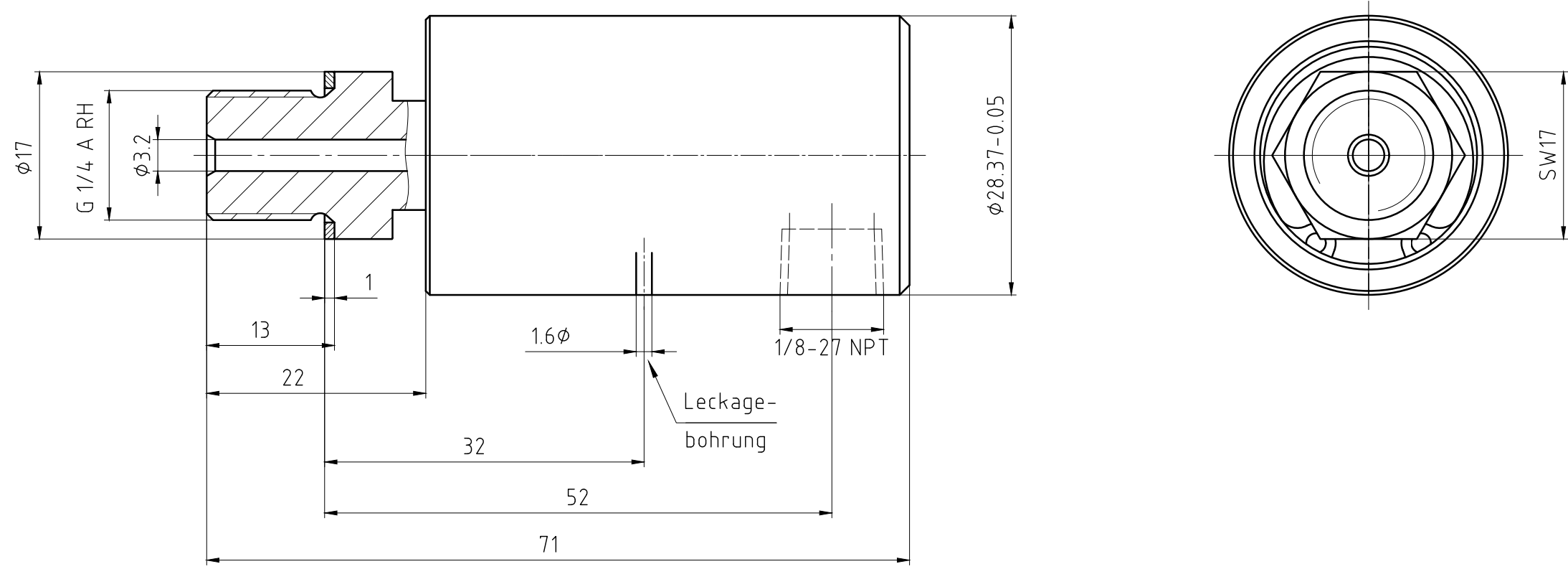

OPERATING DATA / Betriebsdaten		
MEDIA/Medium	HYDRAULIC OIL / COMPRESSED AIR Hydrauliköl / Druckluft	
p max. HYDRAULIC OIL Hydrauliköl	1000 PSI	70 bar
p max. COMPRESSED AIR Druckluft	150 PSI	10 bar
VACUUM/Vakuum max.	28" Hg	6,7 kPa
t max.	250 °F	120 °C
n max.	3500 RPM	3500 1/min

		PROJECTION:	SCALE: 2:1
			MATERIAL: INTERFACE CONTROL DRAWING
		DATE: 01.04.2003 NAME: WRS	TITLE: DEUBLIN UNION DEUBLIN EINFÜHRUNG
		ENGR. 01.04.2003 Ch. Wolf	NO. 1005-020-049
C	UPDATED BORDER	054624 01/20 RM APPD.	UNLESS SPECIFICALLY TOLERANCED, ALL DIMENSIONS ARE CONSIDERED REFERENCE
B	ADDED FAI LAYER	000708 04/08 JK	
a	war 11	02266 20.4.04 Huhn	
ISSUE	MODIFICATION	ECO DATE SIGN	SHEET A3