

NOTES:

1 - WHEN ORDERING UNION FROM DEUBLIN COMPANY, USE PART NUMBER 250-094-020.

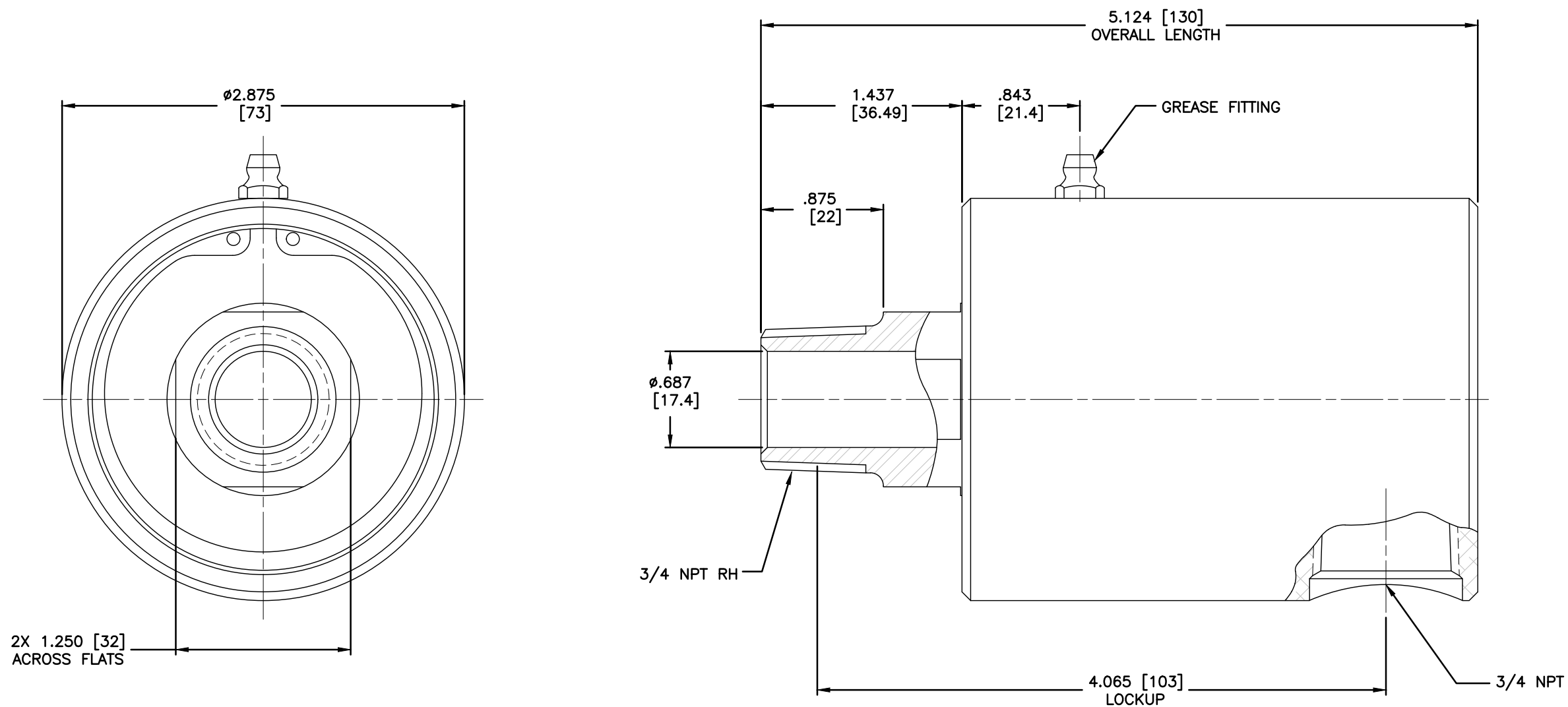

OPERATING DATA:  
 AIR-VACUUM-HYDRAULIC SERVICE  
 150 P.S.I. (10 bar) MAX.AIR SERVICE  
 28" Hg (6,7 KPa) MAX.VACUUM SERVICE  
 1000 P.S.I. (68,9bar) MAX.HYDRAULIC SERVICE  
 1000 R.P.M. (1000/MIN) MAX.SPEED  
 250°F. (121°C.) MAX.TEMPATURE

CONFIDENTIAL  
 THIS DOCUMENT CONTAINS PROPRIETARY INFORMATION  
 AND IS NOT TO BE TRANSMITTED, REPRODUCED, USED  
 OR DISCLOSED TO ANYONE WITHOUT THE WRITTEN PER-  
 MISSION OF THE DEUBLIN COMPANY.

					EQUIPMENT REF:		SCALE 1.66:1	DWG SIZE C
							DRN LG 02/20/02	
							ENGR	
							APPD	
					ASSY/TEST FIXTURES REQUIRED:		UNLESS OTHERWISE SPECIFIED TOLERANCES $\pm .010$ . DIMENSIONS IN [ ] ARE IN MILLIMETERS.	
LET.	REVISION	ECO	DATE	SIGN				