

NOTES:

1 - WHEN ORDERING UNION FROM DEUBLIN COMPANY, USE PART NUMBER 250-685-445.

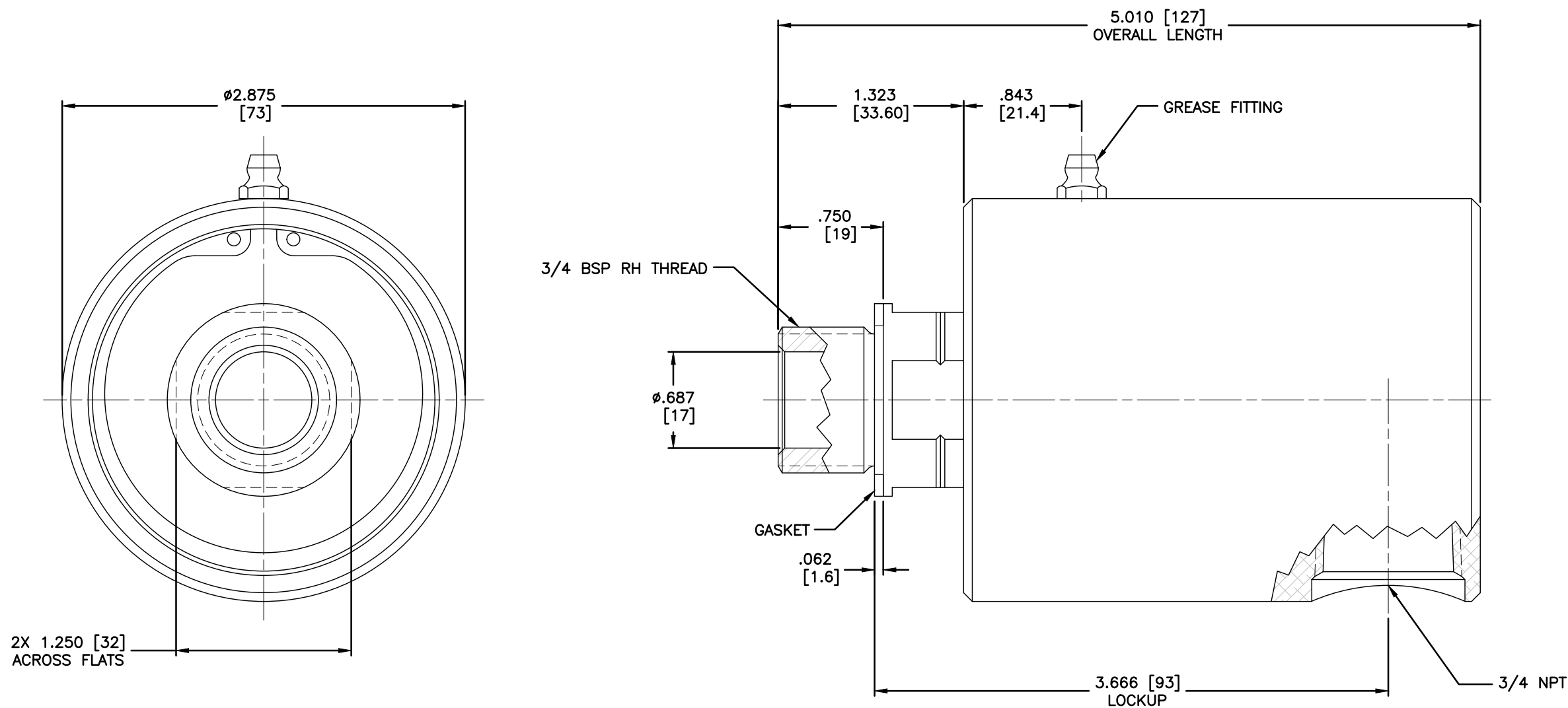

(A) OPERATING DATA:
 HYDRAULIC SERVICE
 1000 P.S.I. (68,9bar) MAX.HYDRAULIC SERVICE
 3500 R.P.M. (3500/MIN) MAX.SPEED
 250°F. (121°C.) MAX.TEMPATURE

CONFIDENTIAL
 THIS DOCUMENT CONTAINS PROPRIETARY INFORMATION AND IS NOT TO BE TRANSMITTED, REPRODUCED, USED OR DISCLOSED TO ANYONE WITHOUT THE WRITTEN PERMISSION OF THE DEUBLIN COMPANY.

				EQUIPMENT REF:		SCALE	1.66:1	DWG SIZE	C
						DRN	RM	01/07/02	DEUBLIN COMPANY WAUKEGAN, ILLINOIS, U.S.A.
						ENGR	ARS	01/07/02	
						APPD	ARS	01/07/02	
				ASSY/TEST FIXTURES REQUIRED:		UNLESS OTHERWISE SPECIFIED TOLERANCES $\pm .010$. DIMENSIONS IN [] ARE IN MILLIMETERS.			TITLE:
									INTERFACE CONTROL DRAWING FOR UNION 250-685-445
A	REMOVED AIR & VACUUM PARAMETERS		12/02	RM					NO. 250-685-445-IC
LET.	REVISION	ECO	DATE	SIGN					C.A.D DRAWING