

CONFIDENTIAL  
 THIS DOCUMENT CONTAINS CONFIDENTIAL AND PROPRIETARY  
 INFORMATION OF DEUBLIN COMPANY. COPYING, USE,  
 TRANSMISSION, DISTRIBUTION, AND DISCLOSURE ARE SUBJECT  
 TO THE TERMS AND CONDITIONS CONTAINED IN YOUR  
 AGREEMENT WITH DEUBLIN COMPANY. ALL RIGHTS RESERVED.

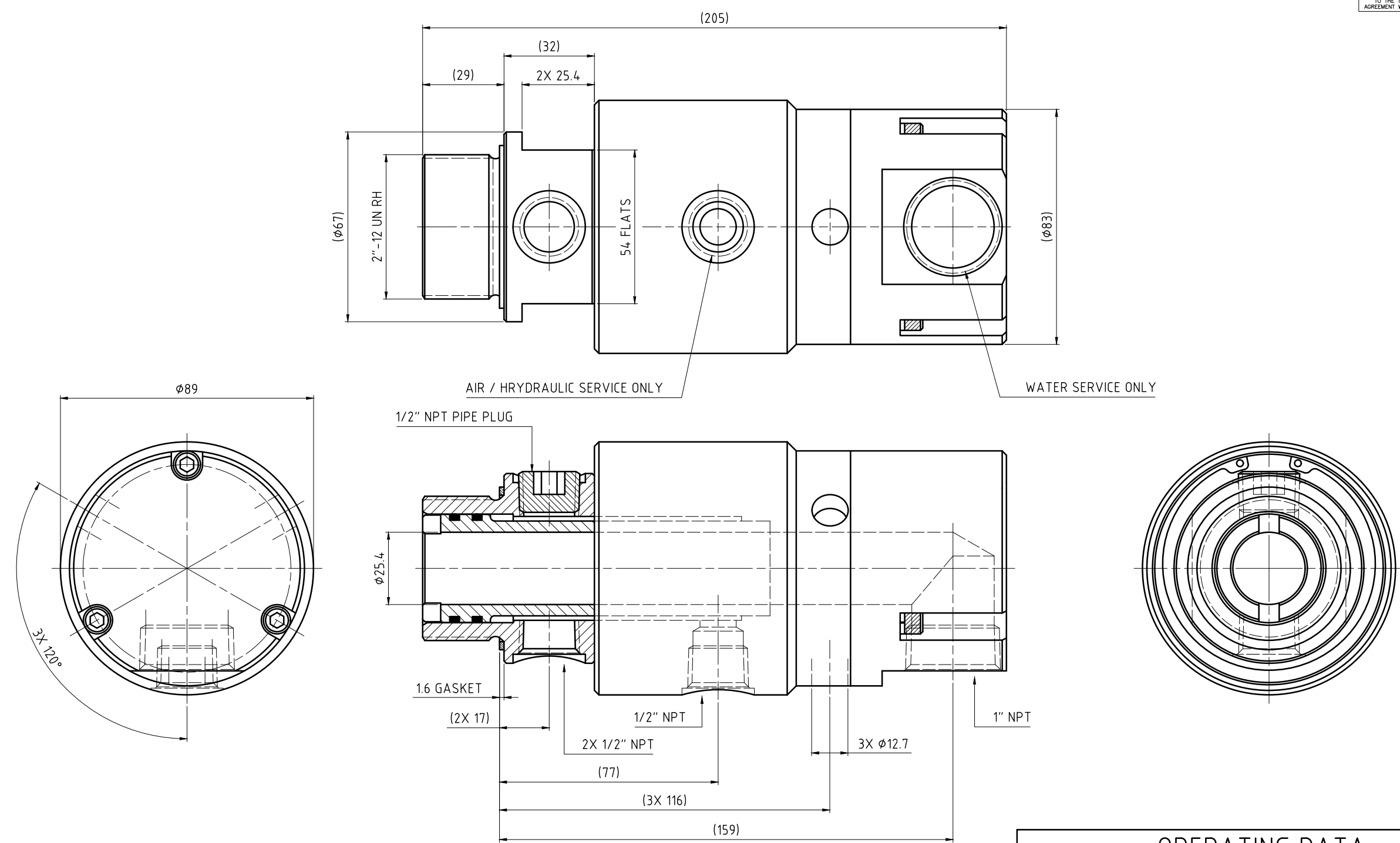

| OPERATING DATA         |         |        |           |
|------------------------|---------|--------|-----------|
| MEDIA                  | WATER   | AIR    | HYDRAULIC |
| MAX. PRESSURE          | 10 bar  | 10 bar | 35 bar    |
| MAX. SPEED             | 350/min |        |           |
| MAX. MEDIA TEMPERATURE | 121°C   |        |           |

|  |              |   |                         |
|--|--------------|---|-------------------------|
|  |              | PROJECTION:<br>   | SCALE: 1:1<br>MATERIAL: |
| DATE: 07/26/11<br>NAME: GA<br>ENGR: 07/26/11<br>APPD: GA                   |              | TITLE: INTERFACE CONTROL DRAWING<br>DEUBLIN UNION 981-300 |                         |
| A UPDATED TO MS 014696 7/11 GA<br>REDESIGN END CAP                         |              | NO. 981-300-IC  |                         |
| ISSUE  | MODIFICATION | ECO   | DATE                    |
| UNLESS SPECIFICALLY TOLERANCED, ALL<br>DIMENSIONS ARE CONSIDERED REFERENCE |              | SHEET<br>A2   |                         |