

NOTES:

- 1 - USE INSTRUCTION MANUAL 040-553!
- 2 - 2X PLUG G 1/4
- 3 - DRAIN PORT, COUPLING G 1/4 FOR 8 mm HOSE

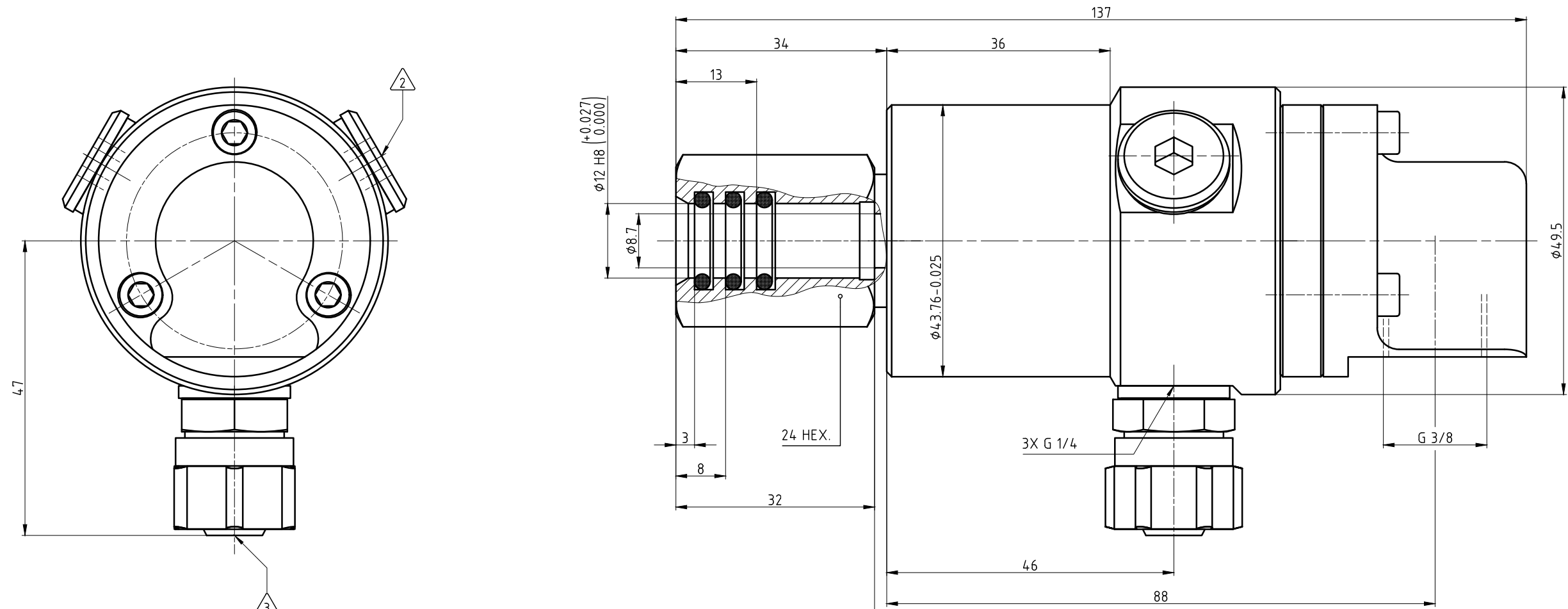

CUSTOMER'S SPINDLE END

| OPERATING DATA |         |                         |                         |
|----------------|---------|-------------------------|-------------------------|
| MEDIA          |         | COOLANT                 | MQL                     |
| PRESSURE       | MAXIMUM | 70 bar                  | 10 bar                  |
|                | MINIMUM | 0.5 bar                 | 0.5 bar                 |
| MAXIMUM SPEED  |         | 12000 min <sup>-1</sup> | 12000 min <sup>-1</sup> |
| FLOW RATE      | MAXIMUM | 82 l/min                | 2039 SLPM               |
|                | MINIMUM | -- l/min                | -- SLPM                 |
| TEMPERATURE    | MAXIMUM | 70 °C                   | 70 °C                   |
|                | MINIMUM | 5 °C                    | 5 °C                    |
| AXIAL FORCE    |         | 11.12 N/bar             |                         |
| DRY RUN        |         | UNLIMITED               |                         |

**DEUBLIN**  
 Engineered for Performance

PROJECTION:

SCALE: 2:1

MATERIAL: INTERFACE CONTROL DRAWING

|       |            |    |
|-------|------------|----|
| DRN.  | 08.04.2011 | FD |
| ENGR. | 08.04.2011 | CW |
| APPD. |            |    |

TITLE: DEUBLIN ROTATING UNION  
 DEUBLIN Drehdurchführung

NO. 902-120-104

SHEET A2

UNLESS SPECIFICALLY TOLERANCED, ALL DIMENSIONS ARE CONSIDERED REFERENCE