

NOTES:

1 - WHEN ORDERING FROM DEUBLIN USE PART NUMBER: 1005-057-019.

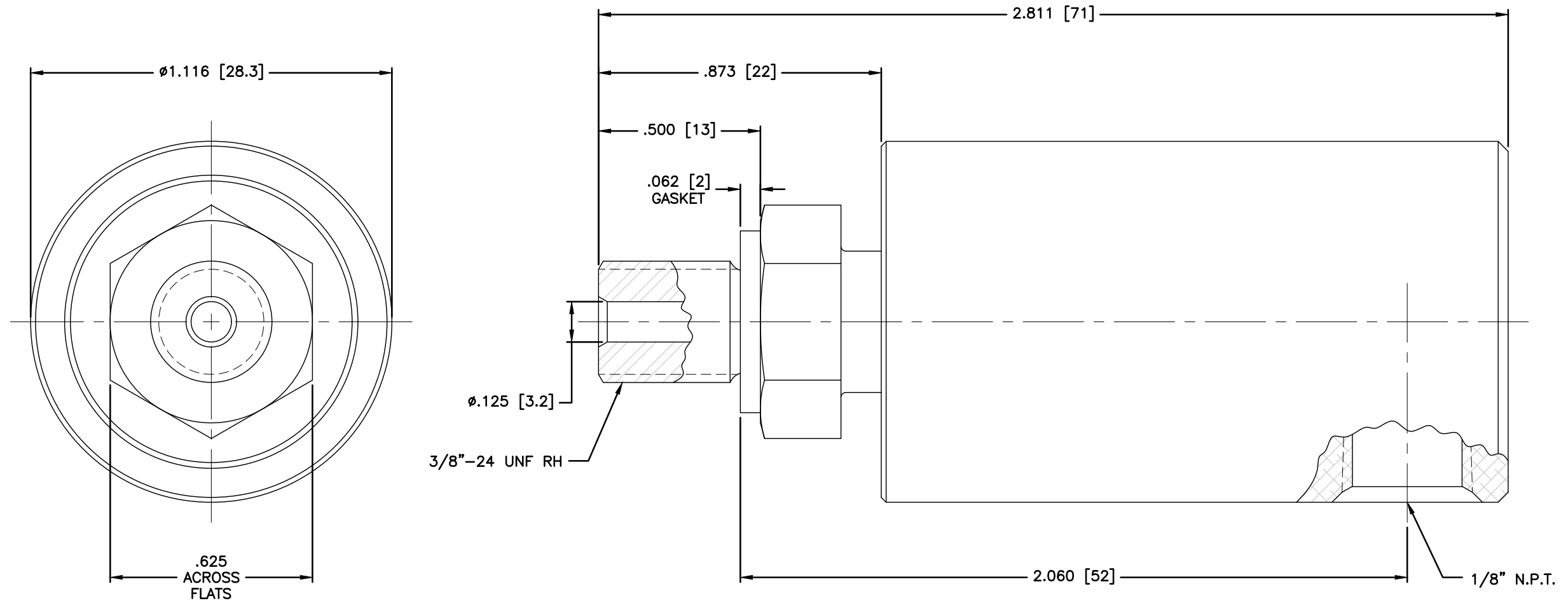

OPERATING DATA		
MEDIA	GREASE & HYDRAULIC	
MAX PRESSURE	1500 PSI	103 bar
MAX SPEED	3500 RPM	3500/min
MAX TEMPERATURE	250°F	121°C

CONFIDENTIAL  
 THIS DOCUMENT CONTAINS CONFIDENTIAL AND PROPRIETARY INFORMATION OF DEUBLIN COMPANY. COPYING, USE, TRANSMISSION, DISTRIBUTION, AND DISCLOSURE ARE SUBJECT TO THE TERMS AND CONDITIONS CONTAINED IN YOUR AGREEMENT WITH DEUBLIN COMPANY. ALL RIGHTS RESERVED.

EQUIPMENT REF:				SCALE	4:1	DWG SIZE	C
ASSY/TEST FIXTURES REQUIRED:				DRN	RM	08/18/03	
				ENGR	ARS	08/18/03	
				APPD	ARS	08/18/03	
				UNLESS SPECIFICALLY TOLERANCED, ALL DIMENSIONS ARE REFERENCE			
				DIMENSIONS IN [ ] ARE IN MILLIMETERS.			
LET.	REVISION	ECO	DATE	SIGN	DEUBLIN COMPANY WAUKEGAN, ILLINOIS, U.S.A. TITLE: INTERFACE CONTROL DRAWING FOR DEUBLIN UNION 1005-057-019 NO. 1005-057-019-IC C.A.D. DRAWING		