

CONFIDENTIAL
 The reproduction, distribution and utilization of this document as well as the communication of its contents to others without express authorization is prohibited. Offenders will be held liable for the payment of damages. All rights reserved in the event of the grant of a patent, utility model or design.

φ18	g4	-0.006	17.994
Maß	Passung	-0.011	17.989

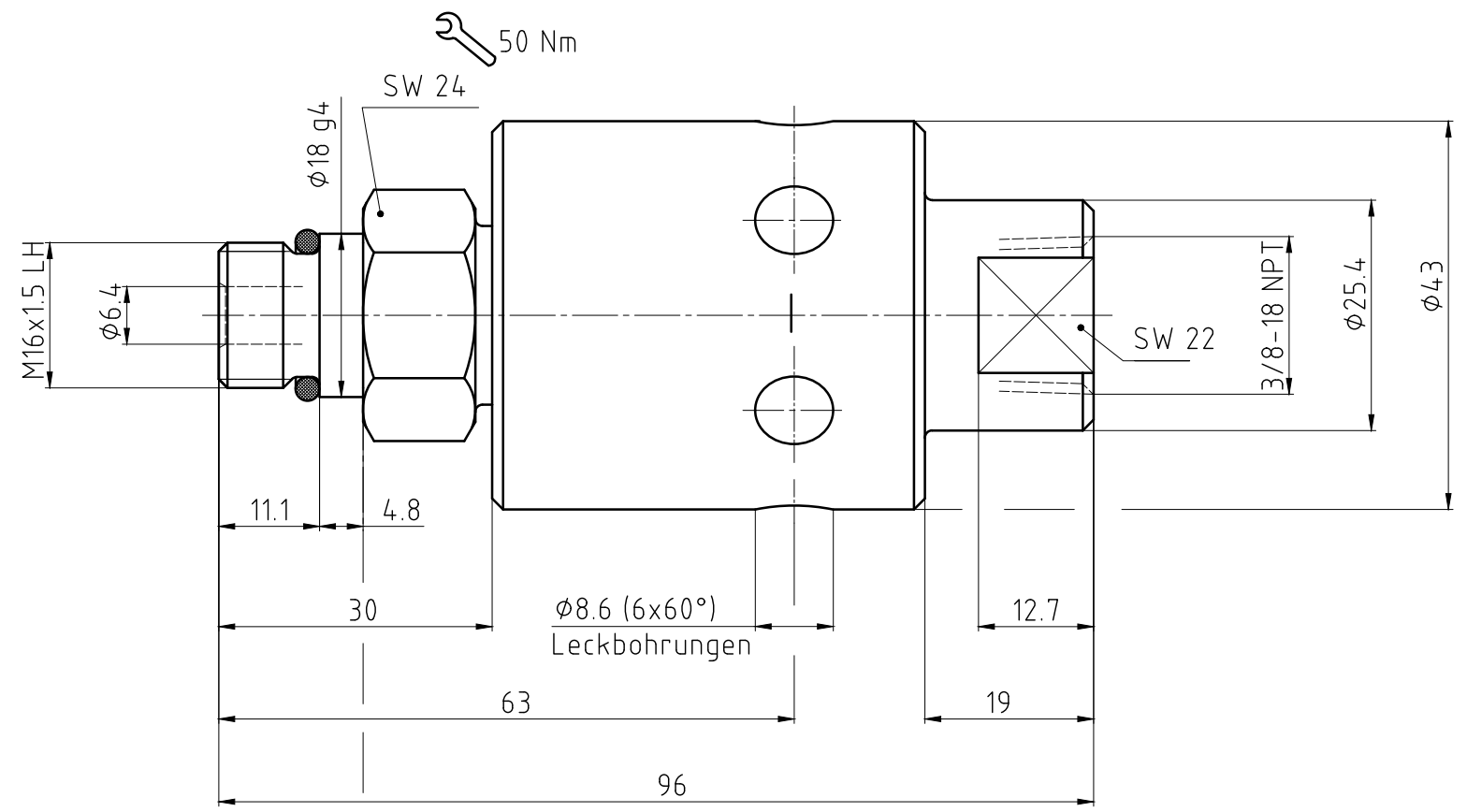

Spindelende des Kunden
 CUSTOMER'S SPINDLE END

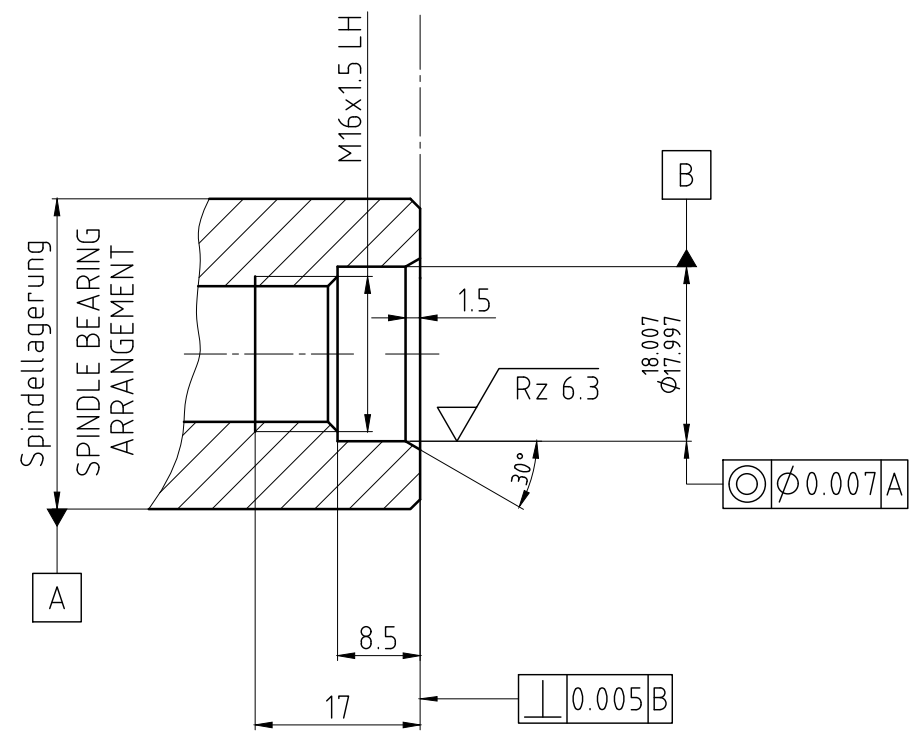

Max. Druck und max. Drehzahl gleichzeitig sind zu vermeiden. Zuordnung siehe Diagramm.
 OPERATION AT MAXIMUM PRESSURE COMBINED WITH MAXIMUM SPEED SHOULD BE AVOIDED. IF THE OPERATING CONDITIONS ARE CLOSE TO THESE LIMITS, LOOK ON THE DIAGRAM.

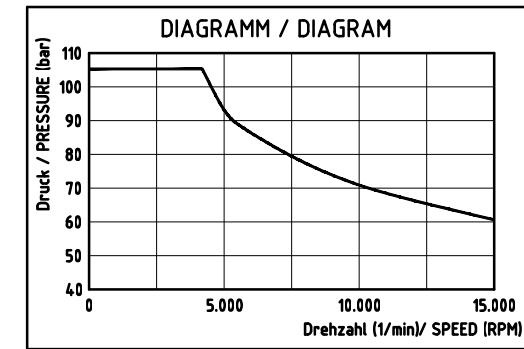

OPERATING DATA / Betriebsdaten		
MEDIA/Medium	COOLANT	KSS
p max.	1500 PSI	105 bar
n max.	15000 RPM	15000 1/min
t max.	160 °F	70 °C
Q max.	4 GPM	15 l/min
FILTRATION/Filterung	60 µm	60 µm

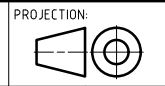

PROJECTION: SCALE: 2:1 Z:\UNIONS\
 MATERIAL: INTERFACE CONTROL DRAWING

ISSUE	MODIFICATION	ECO	DATE	SIGN
c	Updated Bore	054624	01/20	RM
b	METROW/NO DRY RUN	06041	02.03.06	FD
a	Diagram hinzu	φ8.04.03		WRS

DATE: 11.03.2003 NAME: WRS
 ENGR. 11.03.2003 Ch. Wolf
 APPD.
 TITLE: DEUBLIN ROTATING UNION
 DEUBLIN Drehdurchführung
 NO. 1101-235-343 SHEET A2

UNLESS SPECIFICALLY TOLERANCED, ALL DIMENSIONS ARE CONSIDERED REFERENCE