

CONFIDENTIAL
 THIS DOCUMENT CONTAINS CONFIDENTIAL AND PROPRIETARY INFORMATION OF DEUBLIN COMPANY. COPYING, USE, TRANSMISSION, DISTRIBUTION AND DISCLOSURE ARE SUBJECT TO THE TERMS AND CONDITIONS CONTAINED IN YOUR AGREEMENT WITH DEUBLIN COMPANY. ALL RIGHTS RESERVED.

φ16	m7	+0.025 -0.007	16.025 16.007
Maß	Passung		

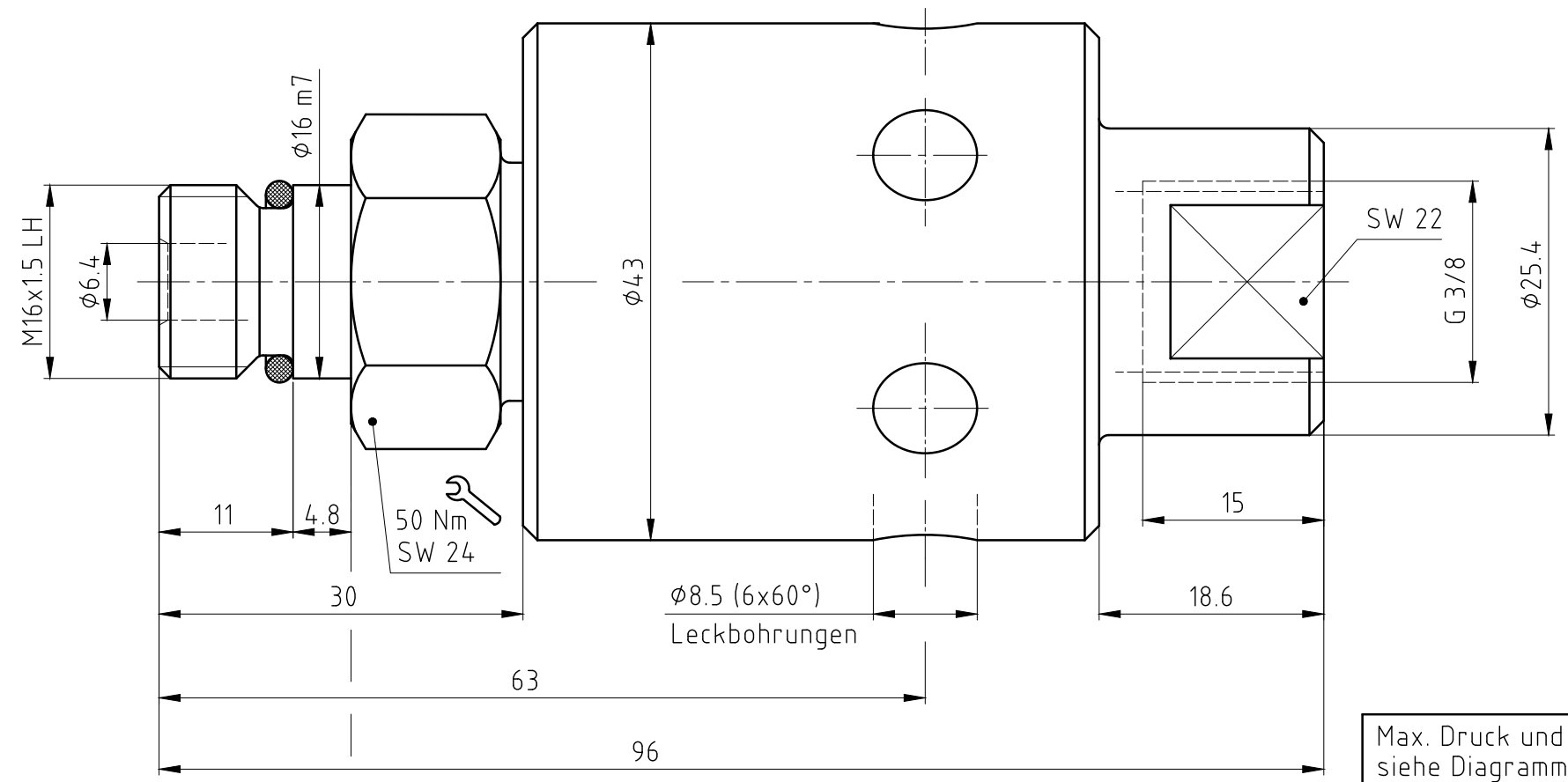

Max. Druck und max. Drehzahl gleichzeitig sind zu vermeiden. Zuordnung siehe Diagramm.
 OPERATION AT MAXIMUM PRESSURE COMBINED WITH MAXIMUM SPEED SHOULD BE AVOIDED. IF THE OPERATING CONDITIONS ARE CLOSE TO THESE LIMITS, LOOK ON THE DIAGRAM.

Spindelende des Kunden
 CUSTOMER'S SPINDLE END

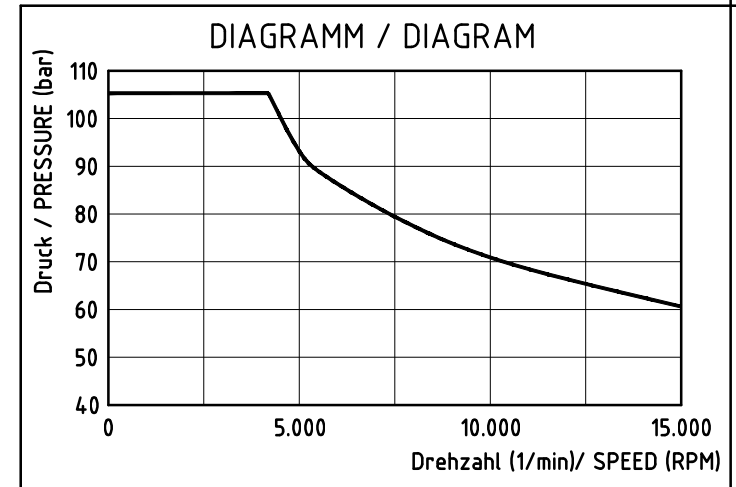
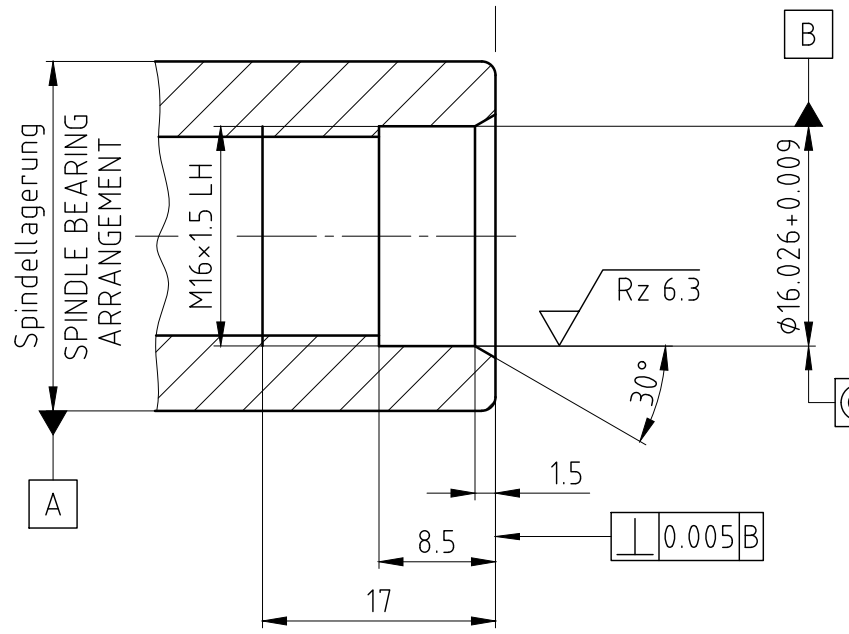

OPERATING DATA / Betriebsdaten		
MEDIA/Medium	COOLANT	KSS
p max.	1500 PSI	105 bar
n max.	15000 RPM	15000 1/min
t max.	160 °F	70 °C
Q max.	4 GPM	15 l/min
FILTRATION/Filterung	60 µm	60 µm

DEUBLIN GmbH D-65719 HOFHEIM-WALLAU, GERMANY	PROJECTION:	SCALE: 2:1	Z:\ \UNIONS\
		MATERIAL:	
DATE	NAME	TITLE:	
DRN. 18.02.2003	WRS	DEUBLIN ROTATING UNION	
ENGR. 18.02.2003	Ch. Wolf	DEUBLIN Drehdurchführung	
APPD.		NO.	SHEET
b METRDWG/NO DRY RUN 06041 02.03.06 FD		1101-359-259-DD	A3
a Diagramm hinzu -- 08.04.03 WRS	UNLESS SPECIFICALLY TOLERANCED, ALL DIMENSIONS ARE CONSIDERED REFERENCE		
ISSUE MODIFICATION ECO DATE SIGN			