

NOTES:

- 1 - OPERATION AT MAXIMUM PRESSURE COMBINED WITH MAXIMUM SPEED SHOULD BE AVOIDED.  
IF OPERATING CONDITIONS ARE MARGINAL, PLEASE CONSULT DEUBLIN ENGINEERING.
- 2 - RECOMMENDED FILTRATION IS 25 MICRONS.
- 3 - DO NOT RUN DRY.

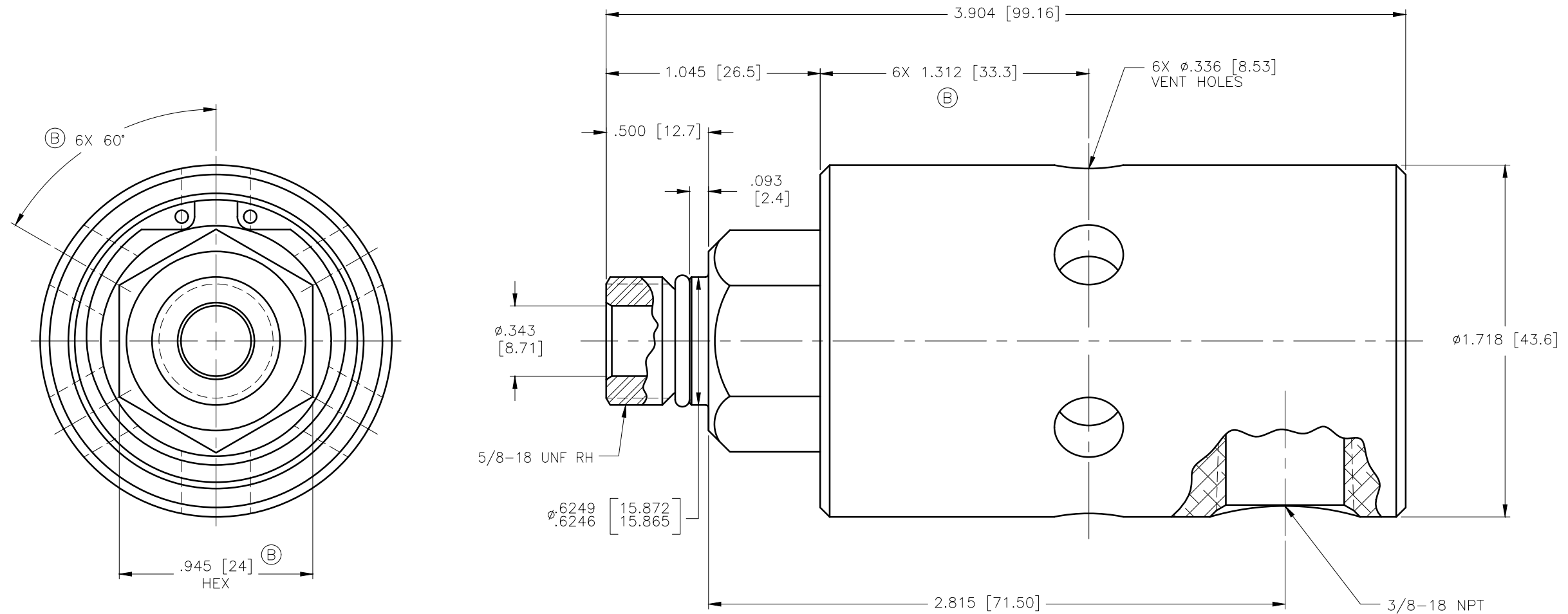

OPERATING DATA		
MEDIA	HYDRAULIC	
MAX PRESSURE	1000 PSI	70 bar
MAX SPEED	12,000 RPM	12,000/min
MAX FLOW RATE	21.6 GPM	82 L/min
MAX TEMPERATURE	160°F	71°C

**CONFIDENTIAL**  
 THIS DOCUMENT CONTAINS CONFIDENTIAL AND PROPRIETARY INFORMATION OF DEUBLIN COMPANY. COPYING, USE, TRANSMISSION, DISTRIBUTION, AND DISCLOSURE ARE SUBJECT TO THE TERMS AND CONDITIONS CONTAINED IN YOUR AGREEMENT WITH DEUBLIN COMPANY. ALL RIGHTS RESERVED.

SCALE	2.5:1	DWG SIZE	C
DRN	RM	01/30/04	
ENGR	TW	01/30/04	
APPD	TW	01/30/04	
PART NO.	1116-672-043		
CUSTOMER			
B	REVISED OPERATING DATA	030130 09/14	NR
A	UPDATED PARAMETERS	EGR 06/07	RM
LET.	REVISION	ECO	DATE SIGN

UNLESS SPECIFICALLY TOLERANCED, ALL DIMENSIONS ARE REFERENCE  
 DIMENSIONS IN [ ] ARE IN MILLIMETERS.

**DEUBLIN COMPANY**  
 WAUKEGAN, ILLINOIS, U.S.A.

TITLE: INTERFACE CONTROL  
 DRAWING FOR DEUBLIN  
 UNION 1116-672-043

DWG. NO. C.A.D. DRAWING