

CONFIDENTIAL

The reproduction, distribution and utilization of this document as well as the communication of its contents to others without express authorization is prohibited. Offenders will be held liable for the payment of damages. All rights reserved in the event of the grant of a patent, utility model or design.

NOTES:

- ① - CONTACT DEUBLIN OR VISIT WWW.DEUBLIN.COM FOR INSTRUCTION MANUAL: 040-550
- ② - PLUG INSTALLED HAND TIGHT FROM FACTORY. IF PORT IS NOT UTILIZED, TIGHTEN BEFORE USE.

③ - GASKET THICKNESS. (A)

(A) ④ - DEPENDING ON COUNTRY OF ORIGIN, HEX STOCK MAY VARY AS NOTED. SEE TABLE FOR ACCEPTABLE WRENCH SIZES.

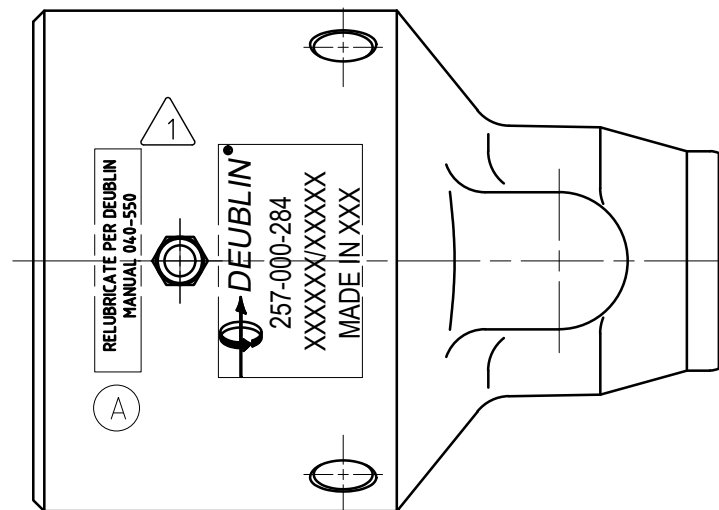
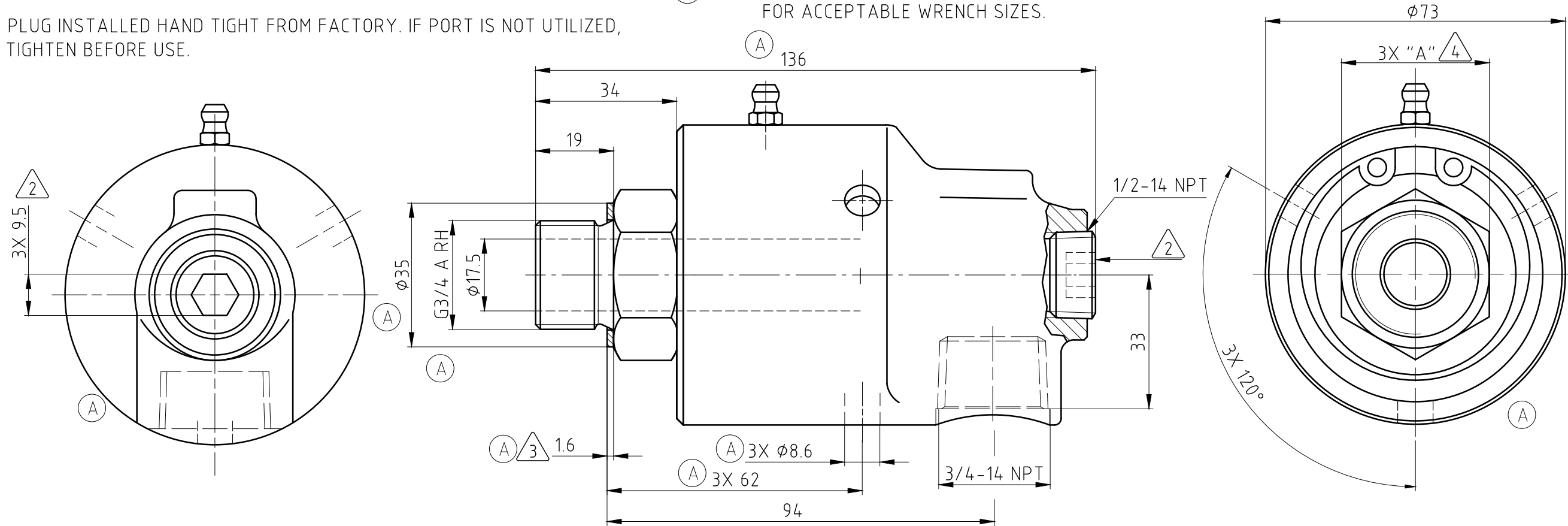

④	HEX SIZES	WRENCHES	
UNITS	"A"	36mm	7/16"
METRIC [mm]	36-0.13	✓	☒
IMPERIAL [in]	1.438-0.006	✓	✓

OPERATING DATA (A)

MEDIA	WATER	SATURATED STEAM (INTERMITTENT)	THERMAL OIL
PRESSURE MAX.	50 bar	1 bar	6.6 bar
SPEED MAX.	3500 min <sup>-1</sup>		
TEMPERATURE MAX.	121 °C		
DRY RUN (WITHOUT ANY MEDIA)	NO		
RECOMMENDED FILTRATION	60 micron		

		PROJECTION:			SCALE: 1:1
		MATERIAL: INTERFACE CONTROL DRAWING		TITLE: DEUBLIN UNION	
		DATE	NAME	NO. 257-000-284	
		DRN. 02/27/20	TG	SHEET A3	
		ENGR. 03/05/2020	RMika		
		APPD.			
A	SEE ECO 058093	11/20	DY	UNLESS SPECIFICALLY TOLERANCED, ALL DIMENSIONS ARE CONSIDERED REFERENCE	
ISSUE/	MODIFICATION	ECO	DATE	SIGN	