

CONFIDENTIAL
 THIS DOCUMENT CONTAINS CONFIDENTIAL AND PROPRIETARY
 INFORMATION OF DEUBLIN COMPANY. COPYING, USE,
 TRANSMISSION, DISTRIBUTION, AND DISCLOSURE ARE SUBJECT
 TO THE TERMS AND CONDITIONS CONTAINED IN YOUR
 AGREEMENT WITH DEUBLIN COMPANY. ALL RIGHTS RESERVED.

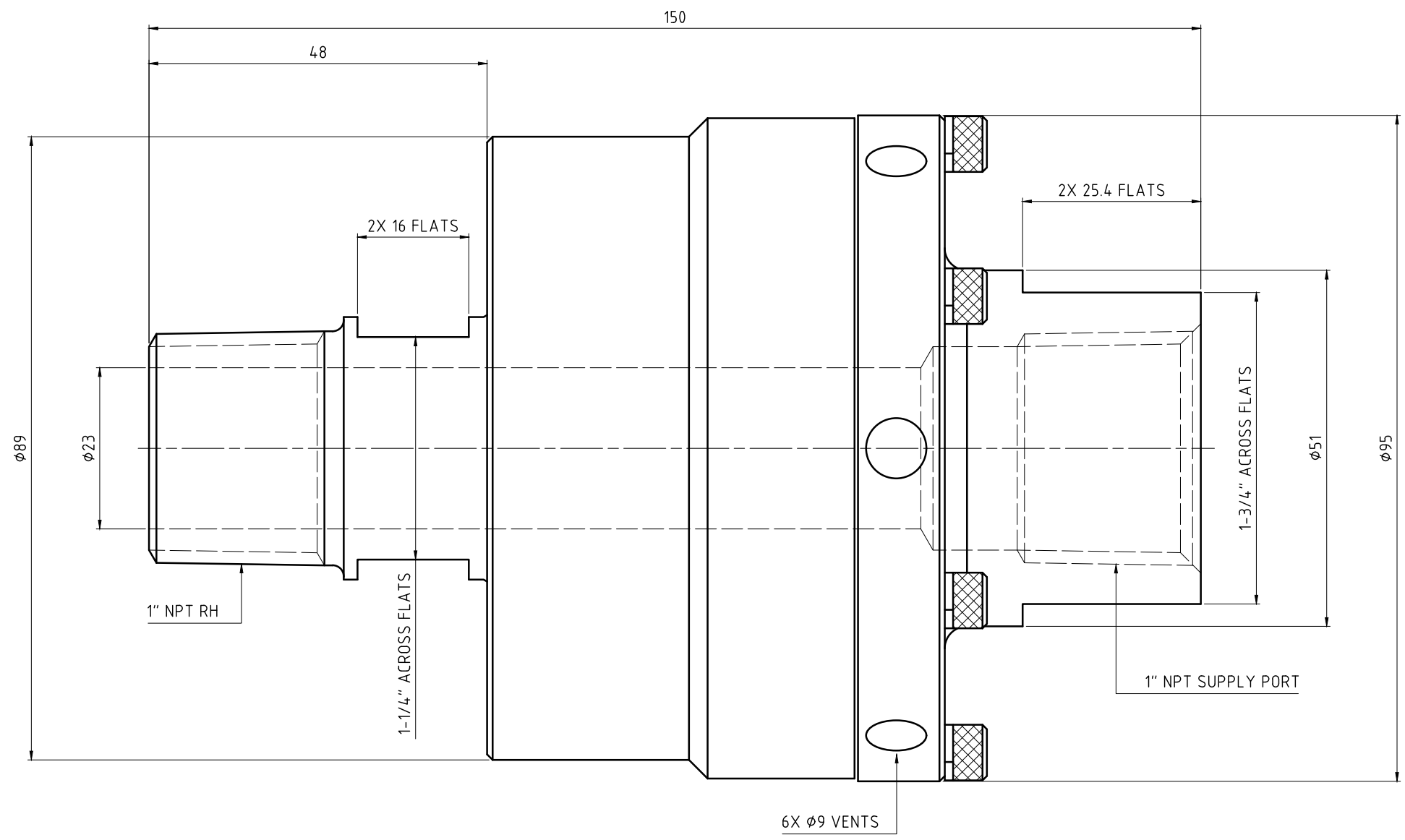

OPERATING DATA:
 BENTONITE DRILL MUD SERVICE
 103 bar MAX. PRESSURE
 250 RPM MAX. SPEED
 106 L/min MAX. FLOW

No. 159-382

		PROJECTION: 	SCALE: 2:1 MATERIAL:
		DATE: 02/11/11 NAME: GA	TITLE: INTERFACE CONTROL DRAWING
		ENGR: 02/11/11 NAME: GA	
		APPD.	
A UPDATE BORDER ISSUE MODIFICATION	0174.4.7 ECO	03/12 DATE	RA SIGN
UNLESS SPECIFICALLY TOLERANCED, ALL DIMENSIONS ARE CONSIDERED REFERENCE			NO. 73010-005-101
			SHEET A3