

NOTES:

- 1 - WHEN ORDERING FROM DEUBLIN USE PART NUMBER: 1116-600-578.
- 2 - OPERATION AT MAXIMUM PRESSURE COMBINED WITH MAXIMUM SPEED SHOULD BE AVOIDED.
IF OPERATING CONDITIONS ARE MARGINAL, PLEASE CONSULT DEUBLIN ENGINEERING.
- 3 - RECOMMENDED FILTRATION IS 25 MICRONS.
- 4 - DO NOT RUN DRY.

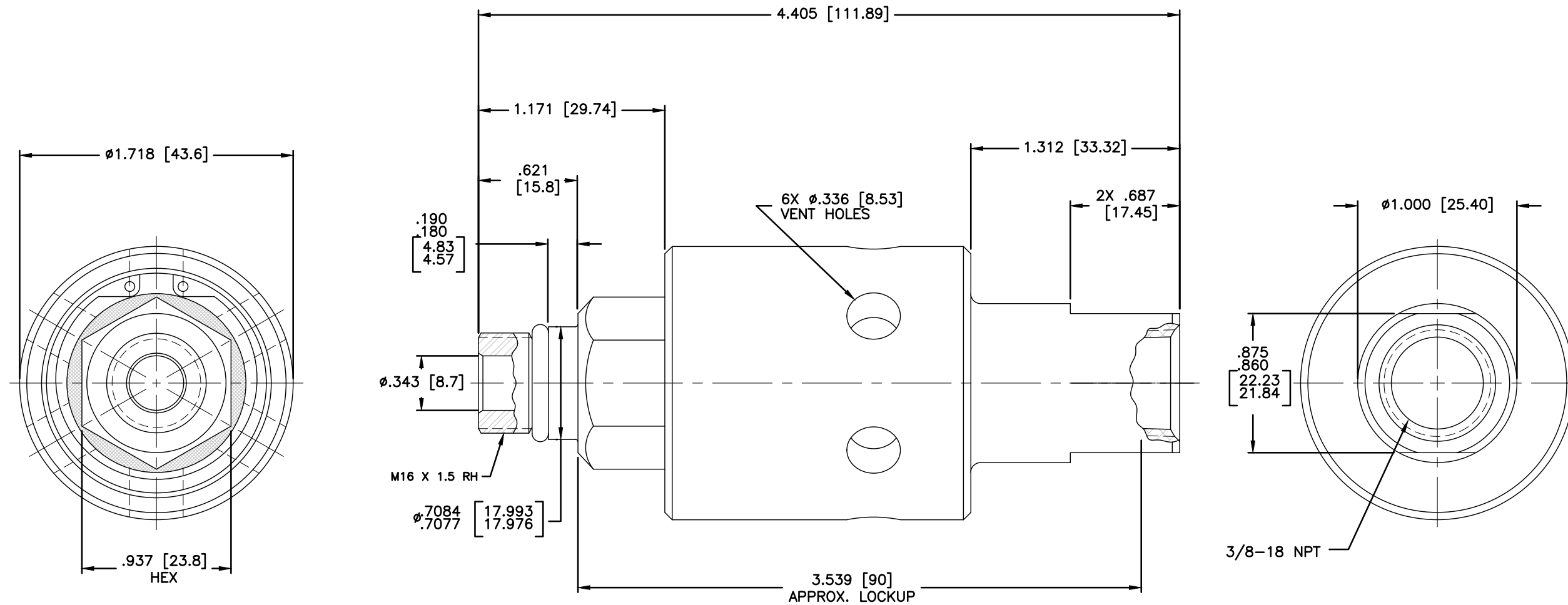

| OPERATING DATA | | |
|----------------------|------------|------------|
| MEDIA | COOLANT | |
| MAX COOLANT PRESSURE | 1000 PSI | 70 bar |
| MAX SPEED | 10,000 RPM | 10,000/min |
| MAX FLOW RATE | 13.8 GPM | 50 L/min |
| MAX TEMPERATURE | 250°F | 121°C |

CONFIDENTIAL
 THIS DOCUMENT CONTAINS CONFIDENTIAL AND PROPRIETARY INFORMATION OF DEUBLIN COMPANY. COPYING, USE, TRANSMISSION, DISTRIBUTION, AND DISCLOSURE ARE SUBJECT TO THE TERMS AND CONDITIONS CONTAINED IN YOUR AGREEMENT WITH DEUBLIN COMPANY. ALL RIGHTS RESERVED.

| | | | |
|----------|--------------|----------|-----------|
| SCALE | 2:1 | DWG SIZE | C |
| DRN | RM | 02/23/06 | |
| ENGR | ARS | 02/23/06 | |
| APPD | ARS | 02/23/06 | |
| PART NO. | 1116-600-578 | | |
| CUSTOMER | | | |
| LET. | REVISION | ECO | DATE SIGN |

UNLESS SPECIFICALLY TOLERANCED, ALL DIMENSIONS ARE REFERENCE
 DIMENSIONS IN [] ARE IN MILLIMETERS.

DEUBLIN COMPANY
 WAUKEGAN, ILLINOIS, U.S.A.
 TITLE: INTERFACE CONTROL
 DRAWING FOR DEUBLIN
 UNION 1116-600-578
 DWG. NO. 1116-600-578
 C.A.D. DRAWING