

NOTES:

- 1 - WHEN ORDERING FROM DEUBLIN USE PART NUMBER: 1116-574-043.
- 2 - OPERATION AT MAXIMUM PRESSURE COMBINED WITH MAXIMUM SPEED SHOULD BE AVOIDED. IF OPERATING CONDITIONS ARE MARGINAL, PLEASE CONSULT DEUBLIN ENGINEERING DEPT.
- 3 - RECOMMENDED FILTRATION IS 25 MICRONS.
- 4 - DO NOT RUN DRY.

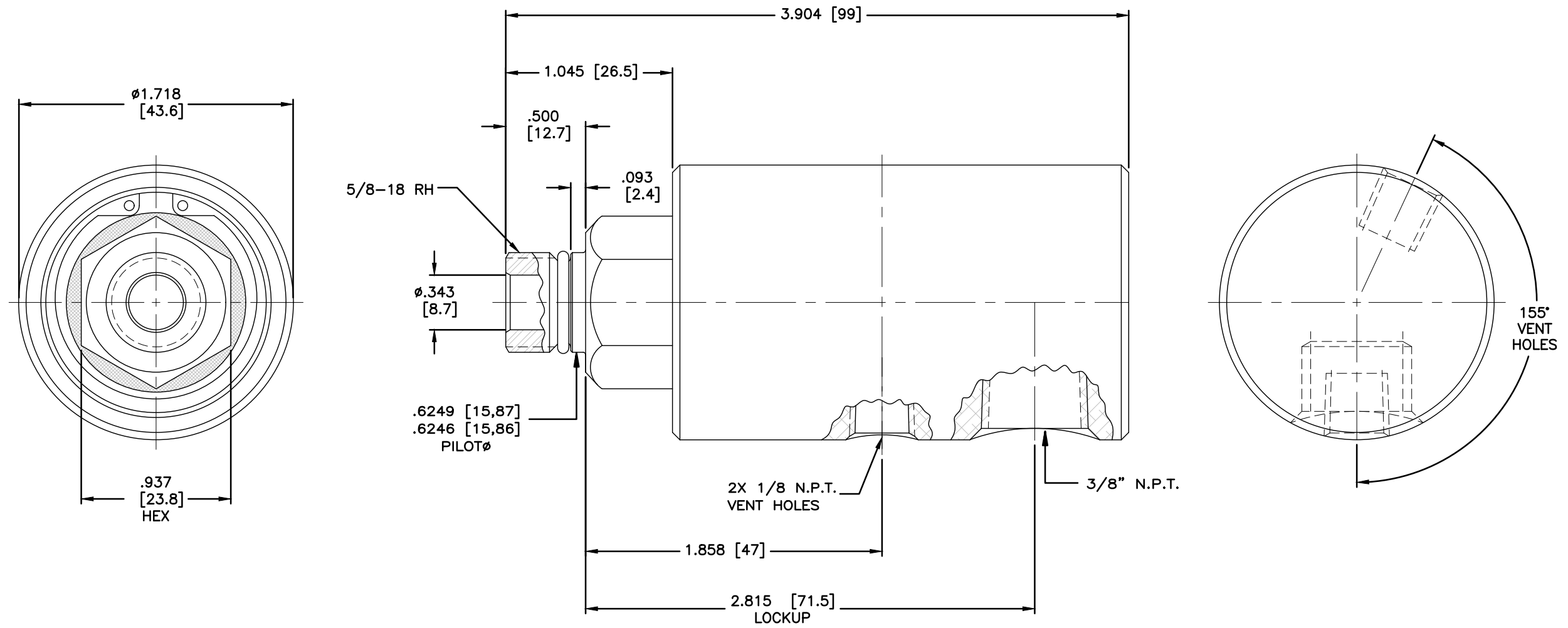

OPERATING DATA		
MEDIA	COOLANT	
MAX COOLANT PRESSURE	1000 PSI	70 bar
MAX SPEED	10,000 RPM	10,000/min
MAX FLOW RATE	13.8 GPM	50 L/min
MAX TEMPERATURE	250°F	121°C

					EQUIPMENT REF:		SCALE: 2:1	DWG SIZE: C	 DEUBLIN COMPANY WAUKEGAN, ILLINOIS, U.S.A.
							DRN: RM	11/05/02	
					ASSY/TEST FIXTURES REQUIRED:		UNLESS OTHERWISE SPECIFIED TOLERANCES ±.010. DIMENSIONS IN () ARE IN MILLIMETERS.		TITLE: INTERFACE CONTROL DRAWING FOR UNION 1116-574-043
									NO. 1116-574-043
LET.	REVISION	ECO	DATE	SIGN					